





Wayne County Administration Building

428 W. Liberty Street Wooster, OH 44691

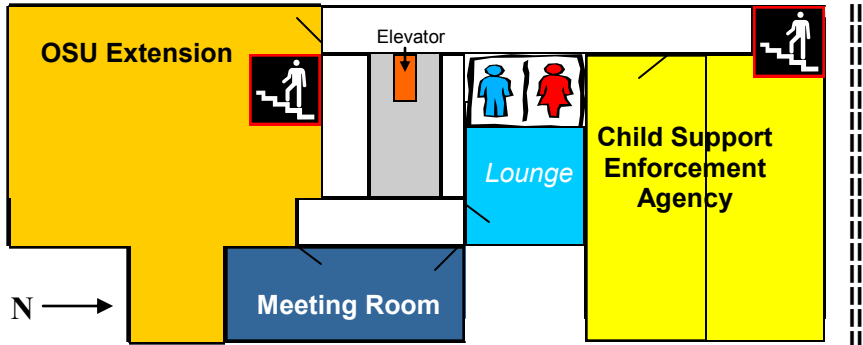

Upper Level

-  OSU Extension
-  Child Support (CSEA)
-  Meeting Room
-  Lounge
-  Public Restrooms



Main Level

-  Auditor
-  Treasurer
-  Recorder
-  Building Code
-  Map Office
-  Wayne County Convention & Visitors Bureau

-  = Hallway
-  = Door Entrance
-  = Stairs

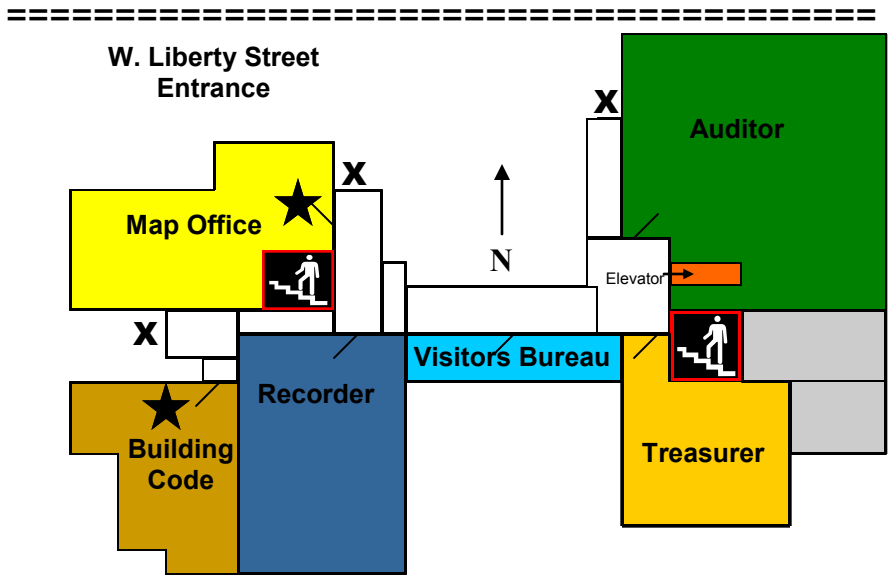

Lower Level

-  Commissioners & Planning Dept.
-  Soil & Water Conservation & NRCS
-  USDA—Farm Service Agency
-  Health Department / Environmental
-  Printing Department
-  Microfilm / Records
-  Wellness Nurse
-  Maintenance
-  Public Restrooms

★ For Building Permits: Please see the other side/page for the CAP process procedure. Use this map to help navigate to different departments located in the same building.

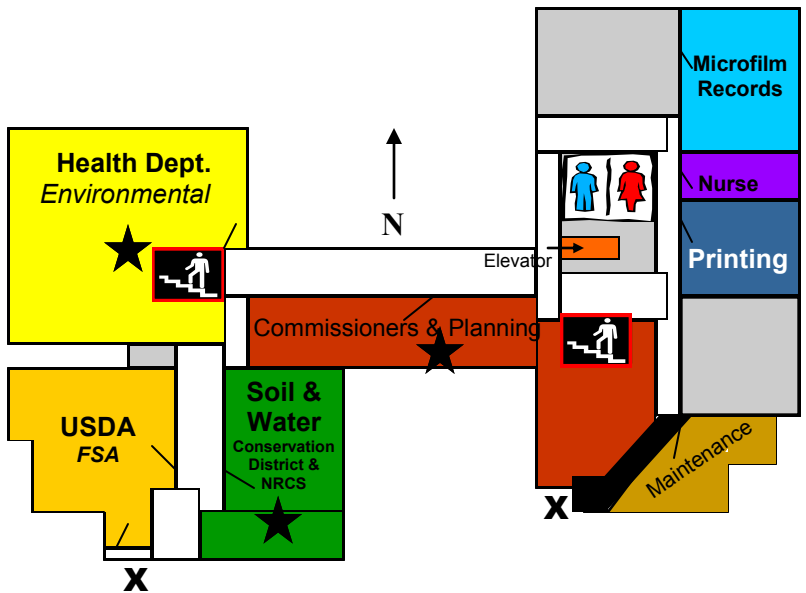

Procedure for Building Permits

1. Building Code Department - Main Level
Drop off plans
2. Map Office - Main Level
Pick up address slip, if it is a new address
3. Wayne Soil & Water Conservation District (SWCD) - Lower Level
Fill out CAP (Construction Application for Permit)
4. Health Department - Lower Level
Septic System Review - signs CAP, if applicable
5. Planning Department - Lower Level
Obtain floodplain permit - signs CAP, if applicable
6. County Engineer's Office - *located at 3151 W. Old Lincoln Way - Obtain permit (for a new drive or other work in a County road R-O-W) - signs CAP, if applicable*
7. Wayne Soil & Water Conservation District (SWCD) - Lower Level
Final signature on CAP
8. Building Code Department - Main Level
Take copy of approved CAP (& floodplain permit)

Other Information

Offices in the County Administration Building are open Monday - Friday.
Visit the Wayne County website at www.wayneohio.org

Building Code Dept: 330-287-5525 Open 7:30am - 4:00pm

Map Office: 330-287-5495 Open 8:00am - 4:30pm
***CLOSED DAILY FROM NOON - 1:00pm**

Wayne SWCD: 330-262-2836 Open 8:00am - 4:30pm
CAP forms available in SWCD office or on the website: www.wayneswcd.org

Health Dept./Environmental Div.: 330-264-2426 Open* 8:00am - 4:30pm
***CLOSED DAILY FROM NOON-1:00pm**

Planning Dept.: 330-287-5420 Open 7:30am - 4:30 pm

Wayne County Engineer: 330-287-5500 THIS OFFICE IS NOT LOCATED IN THE COUNTY ADMINISTRATION BUILDING. (3151 W. Old Lincoln Way, Wooster)

Thank- you!